



Keybridge Tower

1 Exchange Gardens, Vauxhall, SW8 1BG

£1,020 Per Week



Floor Plan

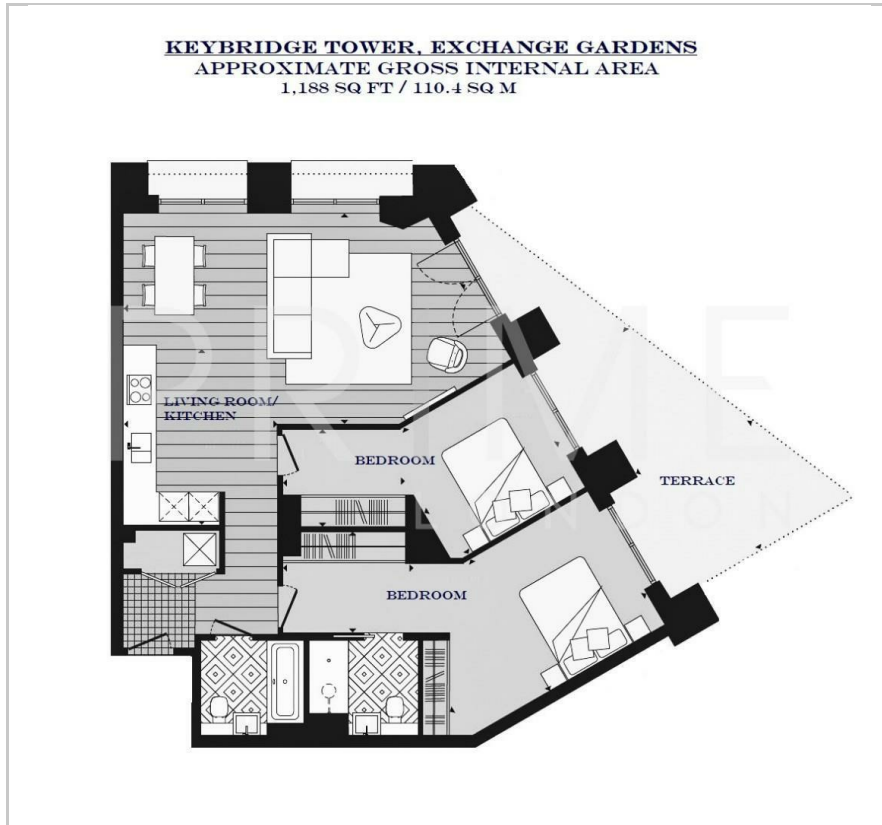

Area Map

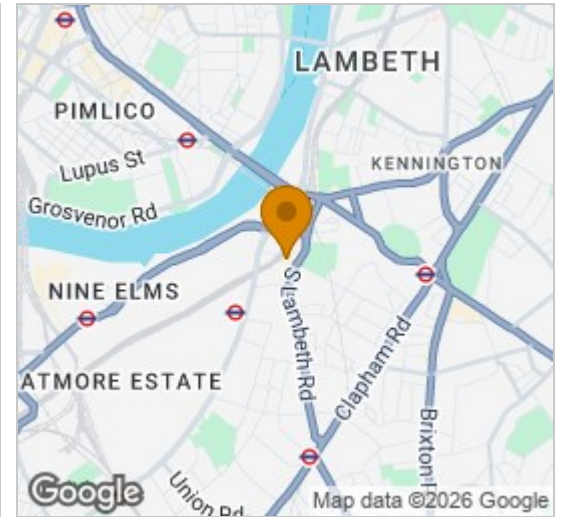

Energy Efficiency Graph

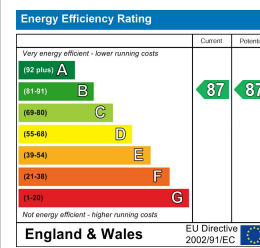

Viewing

By appointment. Contact us on 0207 928 6663 if you wish to arrange a viewing appointment for this property, or require further information.

- Modern two bedroom ▪ 1,188 sq ft (110.4 sqm) apartment
- Fully furnished
- Gym, pool, spa, sauna and steam room
- 24 hour concierge service
- Residents' Club Lounge

This impressive two bedroom apartment, available fully furnished within the sought after warehouse style development Keybridge Tower, is available for lease through Prime London.

The property is an excellent size at 1,188 sq ft (110.4 sqm) with a huge private terrace. Comprising an open plan reception room, smart integrated kitchen, large double bedroom with great storage and a luxury bathroom, the apartment is well designed to be lived in and enjoyed.

Residents benefit from a 24 hour concierge service, 15 metre swimming pool, gymnasium, wellness facilities, a club lounge and communal gardens, all within walking distance of Zone 1 transport links.

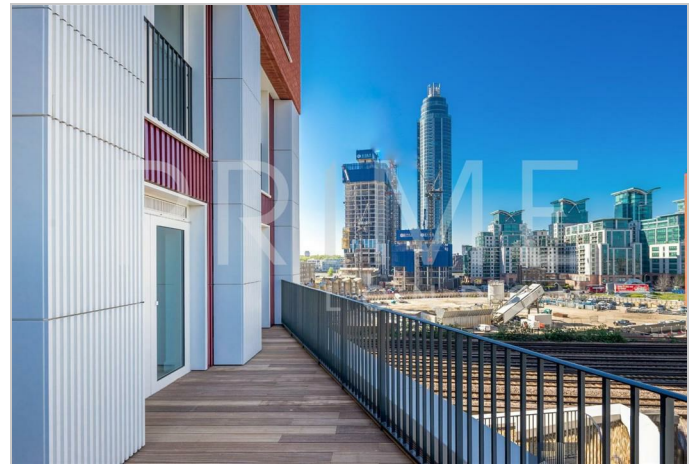

These particulars, whilst believed to be accurate are set out as a general outline only for guidance and do not constitute any part of an offer or contract. Intending purchasers should not rely on them as statements of representation of fact, but must satisfy themselves by inspection or otherwise as to their accuracy. No person in this firm's employment has the authority to make or give any representation or warranty in respect of the property.